

MODEL: SC1400SEL_19
CUSTOMER: -
ADDRESS: -
CITY & STATE: -
JOB: -
LOCATION: -
COMPANY: -

SIZE: DW=	DH=		
MOTOR LOCATION: RIGHT	LEFT		
CONTROL BOX LOCATION: RIGHT	LEFT		
VOLTAGE: ¹ 208V	² 230-240V	480V	² 575V

VISION AREA:		
PANEL COLOR: BLUE	ORANGE	RED
	YELLOW	GREY
VISION AREA: CLEAR PVC	NONE	

OPTIONS:	
3 BUTTON PUSH STATION	-
INDUCTION LOOP	-
MOTION DETECTOR	-

NOTES:

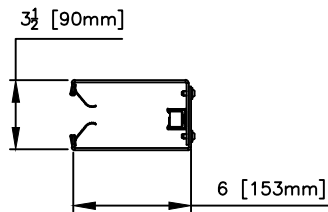

TRACK DETAIL

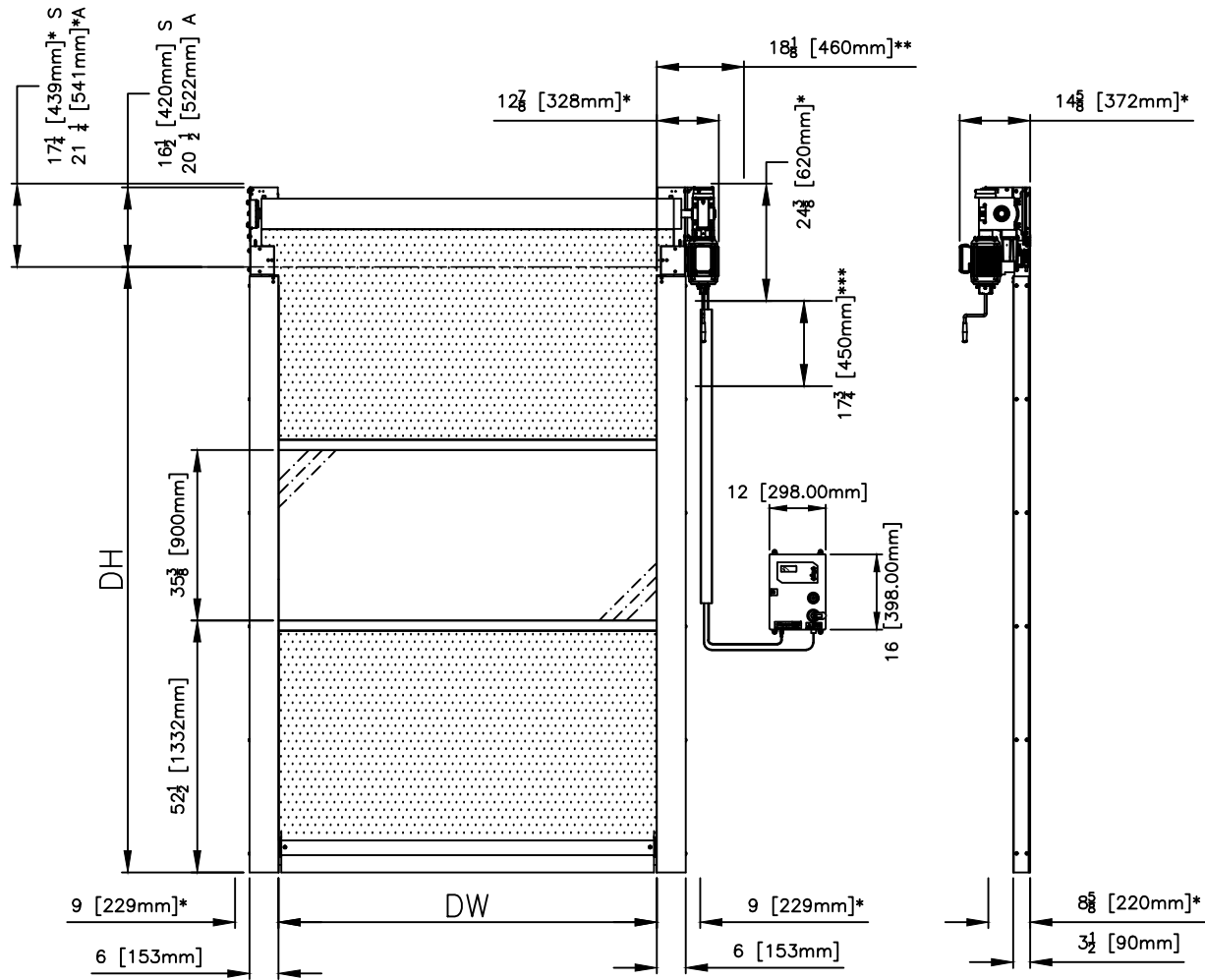

ALL DIMENSIONS ARE IN INCHES [MILLIMETERS].

* FITTING CLEARANCE. (S)softedge (A)luminum

** SPACE NEEDED TO FIT AND DISMANTLE OPERATOR.

*** SPACE REQUIRED FOR CRANK HANDLE.

CONTROL BOX PROJECTION IS 6 INCHES.

DRAWING SHOWN RIGHT HAND, LEFT HAND OPPOSITE.

WE RESERVE THE RIGHT TO CHANGE SPECIFICATIONS WITHOUT NOTICE

HORMANN

117 STARPOINTE BOULEVARD
BURGETTSTOWN, PA 15021-9506
PH: +1 (800) 365-3667 FAX: 724.385.9151
www.hormann.us

TITLE: HIGH PERFORMANCE DOOR SPECIFICATIONS		
MODEL: SC1400SEL_19	PART #:	
DRAWING #:	PAPER SIZE:	
PAGE:	SCALE:	
QTY:	ENGINEER: GJB	DRAWN: 3/2/2021