



CLIMA ELITE 5800

Insulated Carriage Style Garage Doors

■ **NEW**

HÖRMANN



Clima Elite 5800

BEST



Door: Ltd Lifetime



Hardware: 5 yr



Springs: 3 yr

THERMAL RATING



0.21



15.7

Note: A lower U-Factor number indicates a higher efficiency

- Steel Construction
- 2" Door
- 1-1/2" Polyurethane Insulation
- White (Field Paint Option)
- 144 Panel + Window Designs

Thermal Rating



Customizations



Low Maintenance



Luxury Level



Section Detail

SECTION DETAIL

Our Clima Elite window mullion has no joints, attractive detailing, and crisp corners. Glass is sealed with bonding tape around the perimeter of the window and on the back of the grid, providing superior weather protection and greater ease when field painting.

Clima Elite 5800

Panel Features

Timeless Carriage-House Looks with Unbeatable Energy-Efficiency

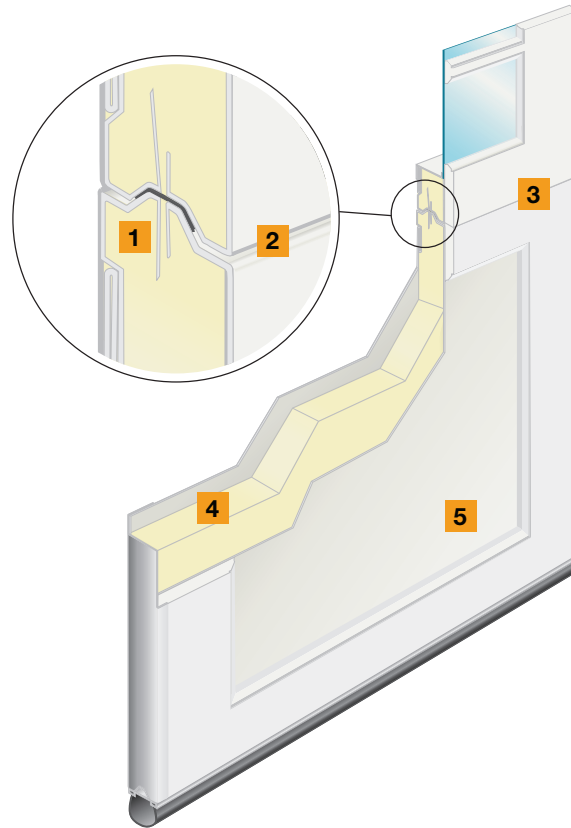

Precise Thermal Break **1**

Increased thermal efficiency is achieved by our conduction-resistant thermal break.

Insulated Tongue & Groove **2**

Our joints are sealed with insulating foam and joint tape to reduce air flow and heat loss.

Custom Overlays on Smooth Polyurethane Insulated Panels **3**

Custom-machined overlay material enables multitudes of design options along with the beauty of recessed window placement. Smooth, triple-reinforced steel extends across the entire section for robust hardware mounting. An internal steel layer creates additional stability.

Proprietary Urethane Blend **4**

Perfected over generations, our precisely-engineered polyurethane outperforms its competitors in strength, energy efficiency, and density every time.



Steel Construction **5**

Our top-of-the-line galvanized steel is treated with 4 layers of strength and weather resistance.

Panel Design Groups L & M

CHOOSE YOUR PANEL DESIGN.

Panels come in four different styles allowing you to choose the perfect match for the design of your home.

					1 D0LOS
					2 D1LOS
					3 D2LOS
					4 DALOS
					5 DVL0S
					6 D0LOA
					7 D1LOA
					8 D2LOA
					9 DAL0A
					10 DVL0A
					11 D0M0S
					12 D1M0S
					13 D2M0S
					14 DAM0S
					15 DVM0S
					16 D0M0A
					17 D1M0A
					18 D2M0A
					19 DAM0A
					20 DVM0A
					21 DXM0S
					22 DXMXS
					23 DKM0S
					24 DXM0A
					25 DXMXA
					26 DKM0A

Clima Elite 5800

Panel Design Options

Panel Design Groups

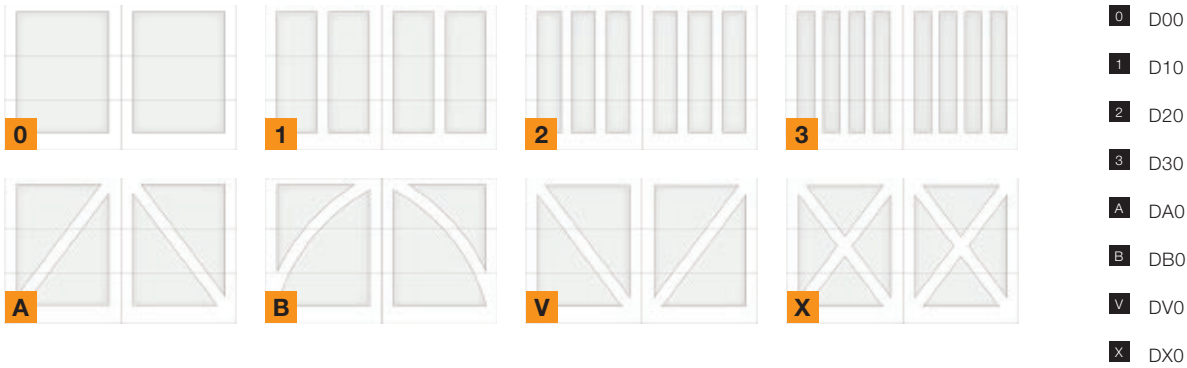

Window Designs

Pair any panel design from the above groups (0, 1, 2, 3, A, B, V, X) with any window layout below.

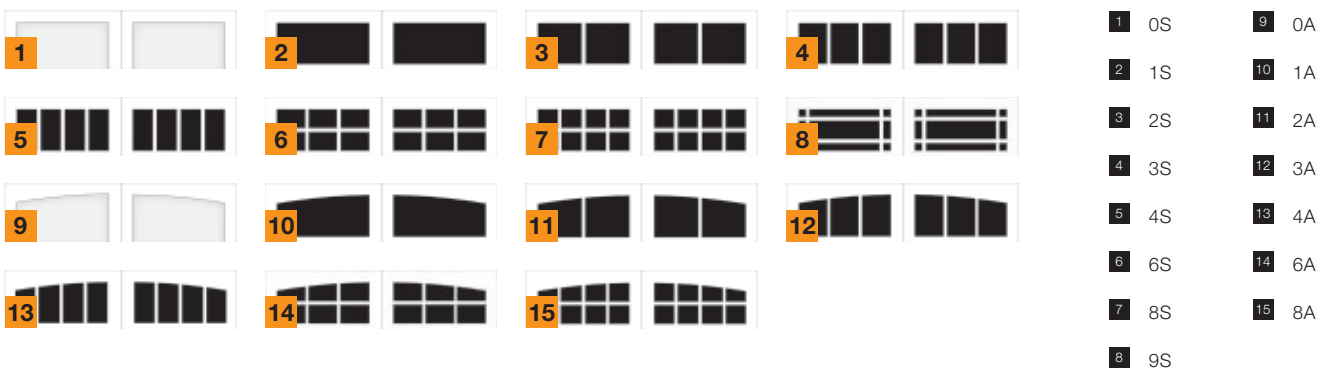

Mix & Match

By mixing and matching panel designs with window designs you can create all sorts of looks to perfectly match your home's aesthetic.

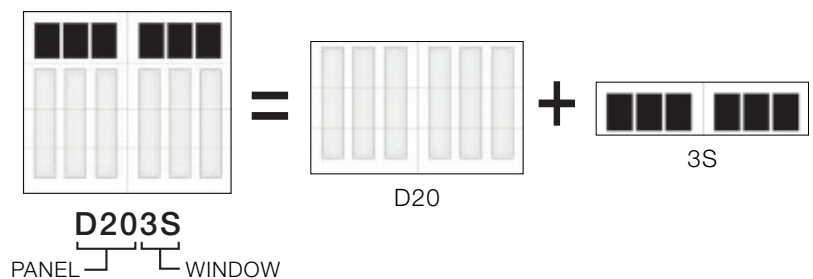

Glass Options

*Glass Options are available in uninsulated or insulated variants

**Laminate glass options not available in insulated variant



- 1 Clear
- 2 Bronze
- 3 Satin Etch
- 4 Gluechip
- 5 Privacy
- 6 Mistlite
- 7 Obscure
- 8 Gray

Decorative Hardware Options

Enhance the look of your garage door with our attractive powder coated decorative hardware kits.

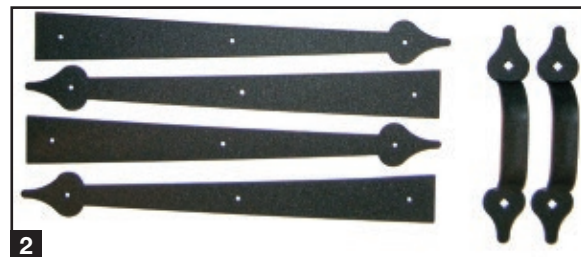

- 1 Deco Kit B - Malleable Iron
- 2 Deco Kit C - Stamped Steel

HÖRMANN NORTH AMERICA



Sparta, TN - North American Headquarters / Sectional Doors

SIX PRODUCTION PLANTS, ONE FAMILY

As one of the world's leading manufacturers of door systems, we're committed to providing the best quality, value, and selection. Whether residential, commercial or industrial, we have the solutions you're looking for. Each Hörmann product gives you the perfect array of benefits and options to satisfy your customers.



Puyallup, WA



Montgomery, IL



Barrie, ON Canada



Burgettstown, PA



Imperial, PA

USA

Toll Free: 800.365.3667
Email: info@hormann.us
Website: hormann.us

Canada

Toll Free: 866.792.9968
Email: info@hormann.ca
Website: hormann.ca

Mexico

Toll Free: 52 (81) 8308 7481
Email: info@hormann.com.mx
Website: hormann.mx



AVAILABLE FROM:



PN 27805365

Follow us on social media



We reserve the right to change specifications without notice. ©Hörmann (Issue 2.2025)