

Modern Tech 3550



BETTER

Door: Ltd Lifetime
 Hardware: 3 yr
 Springs: 3 yr

- **R-10.4** Thermal Rating
- 24 ga. Steel
- 2" Sections
- 6 Colors
- 40+ Designs

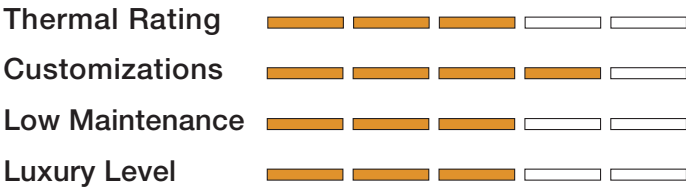

PANEL DESIGN OPTIONS

				1 AFL
				2 AFR
				3 AI
				4 AT
				5 BFL
				6 BFR
				7 BI
				8 BT
				9 CFL
				10 CFR
				11 CFL2
				12 CFR2
				13 CFLR
				14 CI
				15 CT

				1 AFL
				2 AFR
				3 AFLR
				4 AT
				5 AFL2
				6 AFR2
				7 AI
				8 BFL
				9 BFR
				10 BFLR
				11 BT
				12 BFL2
				13 BFR2
				14 BI
				15 CFR
				16 CFL
				17 CFLR

SAFETY, DURABILITY, EFFICIENCY

Black satin, dark bronze, brushed nickel, and white never looked so good. These contemporary panel colors are standard on the Modern Tech 3550 and have the refined appearance of aluminum though are smooth, heavy-duty 24-gauge steel.

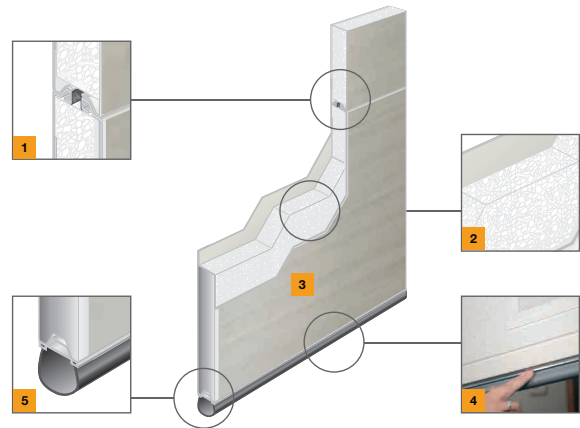

Tongue & Groove Section Joints **1**

Precisely designed thermally broken section joints reduce air infiltration and create weathertight seal.

Sandwich Construction **2**

3-layer steel front and back construction with insulating polystyrene core increases energy savings.

Smooth Steel Texture **3**

Heavy-duty 24 gauge steel exterior skin comes in four attractive colors.

Aluminum Retainer **4**

Hörmann minimizes floor corrosion by utilizing an aluminum bottom seal retainer that never rusts and is more durable than brittle plastic retainers.

Bottom Weather Seal **5**

Keeps out wind, rain, debris and other elements for added energy savings.



Section Detail

Modern Tech panels are produced in smooth heavy-duty 24 gauge exterior skin. All doors are customizable with 46 panel and window combinations and include high quality painted aluminum frame with clear annealed glass.

COLOR OPTIONS

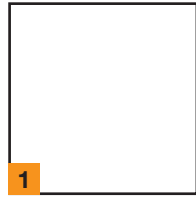

1



2

- 1 White
- 2 Black Satin
- 3 Dark Bronze
- 4 Brushed Nickel
- 5 Patina
- 6 Graphite



3



4



5



6

GLASS OPTIONS



1



2



3



4



5



6



7



8

- 1 1/4" Clear
- 2 1/8" Bronze
- 3 1/8" Satin Etch
- 4 Gluechip
- 5 1/8" Privacy
- 6 1/8" Mistite
- 7 1/8" Obscure
- 8 Gray



USA

Toll Free: 800.365.3667
 Email: info@hormann.us
 Website: hormann.us

Canada

Toll Free: 866.792.9968
 Email: info@hormann.ca
 Website: hormann.ca

Mexico

Toll Free: 52 (81) 8308 7481
 Email: info@hormann.com.mx
 Website: hormann.mx



AVAILABLE FROM:



Follow us on social media

