

Technical manual

Revised 06.2023

HPP Impact Traffic Doors

HPP-180

HPP-360



Hörmann Impact Traffic Doors

Food-safe double-action doors made of heavy-duty polyethylene (PE)

Durable and hygienic doors for an array of applications

Hörmann High Performance Polyethylene (HPP) Impact Traffic doors are made from heavy-duty polyethylene PE 500 material which is impact and break-resistant. When combined with our special impact-resistant stainless steel hinges, our HPP doors can withstand years of wear and tear, even when subjected to extremely high stress forklift impacts.

Hörmann Impact Traffic doors are impervious to moisture, resistant to acids and alkalis, and meet the most stringent hygiene standards. They are ideal for use in cold temperatures, wash down applications, and food production environments. This material is USDA / FDA / EU compliance with a ten year panel warranty and a one year warranty on all other components.



Contents

Contents	Page
HPP-180 Impact Traffic Door	
Technical data	04
Size range	05
Installation types	06 – 09
HPP-360 Impact Traffic Door	
Technical data	10
Size range	11
Installation types	12 – 15

No part may be reproduced without our prior permission.
All rights reserved
All dimensions in inches
Subject to design changes

HPP-180 Impact Traffic Door

Technical data

Fastening according to wall type

Technical data		HPP-180
Use	Internal door	●
	External door	—
Door panel sizes	Minimum width single-panel	16
	Minimum width double-panel	31
	Maximum width single-panel	63
	Maximum width double-panel	126
	Minimum height	71 *
	Maximum height	181
Wind load resistance		—
Window	rectangular	●
	round	●
	Crescent	○
Window material	Acrylic glass 5/8 inch	●
Window frame material	Polyethylene	○
	Stainless steel V2 A	○
	Stainless steel V4 A	○
Door panel material	Polyethylene PE 500, pressed, 5/8 inch	●
Hinge material	Stainless steel V2 A	●
	Stainless steel V4 A	○
Finger protection	Without PVC finger guard	●
	PVC finger guard	○
	PVC finger guard, cold-resistant	○
Installation type material	Mounting plate 6 × 3 × 1/8 inch V2A	●
	Mounting plate 6 × 4 × 5/32 inch V2A	●
	Stainless steel flat profile 3 × 1/8 inch V2A	●
	Stainless steel flat profile 4 × 7/16 inch V2A	●
	Profile frame (PU insulated panel, 2 inch frame face) V2A	●
	Profile frame (drywall, frame face 3 inch) V2A	●
	Profile frame (brickwork, 4 inch frame face) V2A	●
	Block frame in front of the wall 4 × 2 inch V2A	●
	Installation methods optionally in V4A	○
Suitable temperatures		-22 °F to 140 °F

● = Standard ○ = Optional * = smaller on request

Material characteristics acc. to (EC) 1935/2004 and (EU) 1245/2020, performance characteristics acc. to EN 14351-2

Fastening according to wall type

	Mounting plate	Flat profile	Profile frame	Block frame in front of the wall
Brickwork / concrete	●	●	●	●
Existing frame	●	●	●	●
Drywall, reinforced	●	●	●	●
Drywall, not reinforced	—	—	●	●
Insulated panels	—	—	●	●

PE Impact Traffic door HPP-180

Size range

(all dimensions in inches)

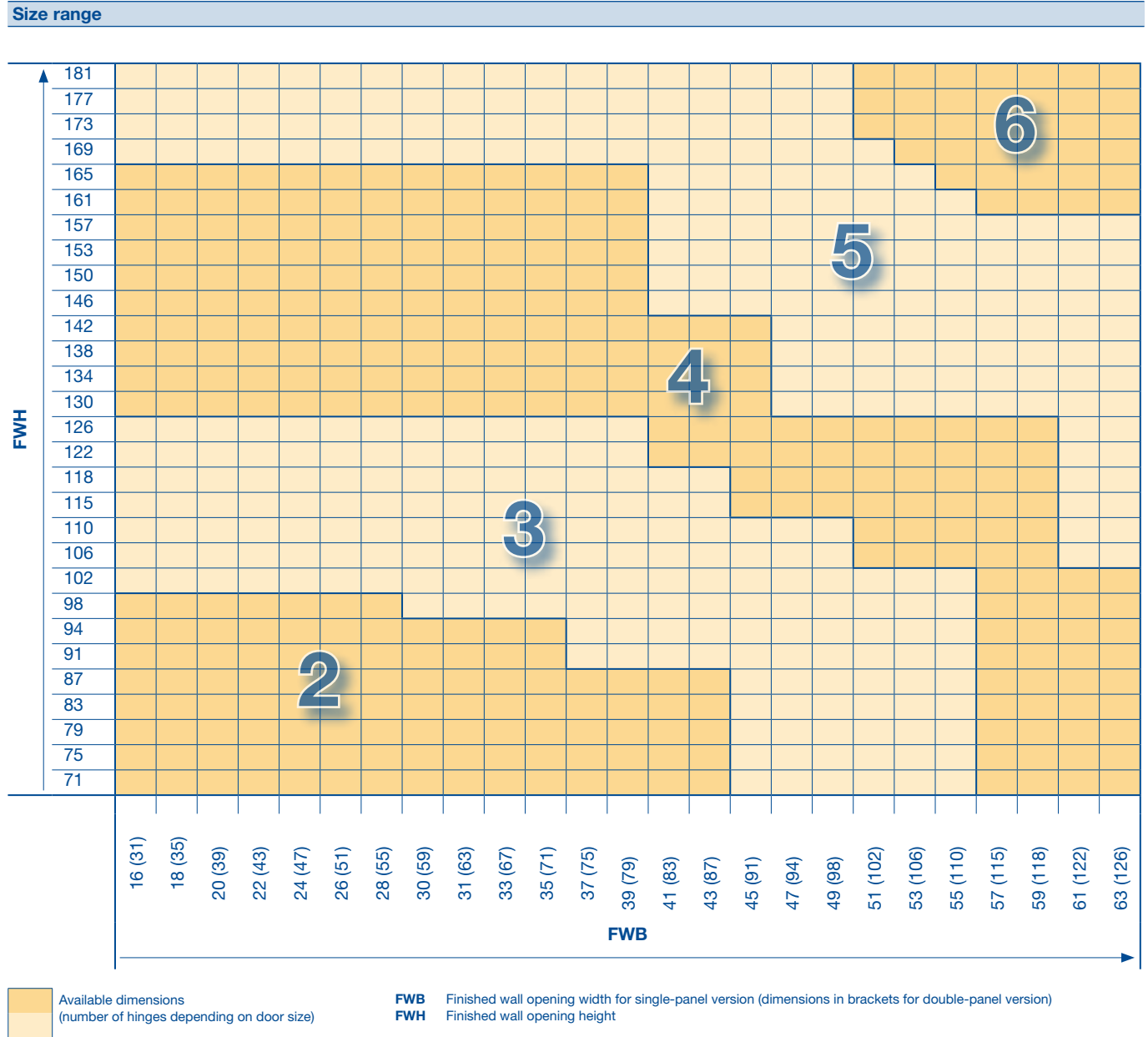

PE Impact Traffic door

HPP-180

Installation types for single-panel Impact Traffic doors

(all dimensions in inches)

Installation in the opening

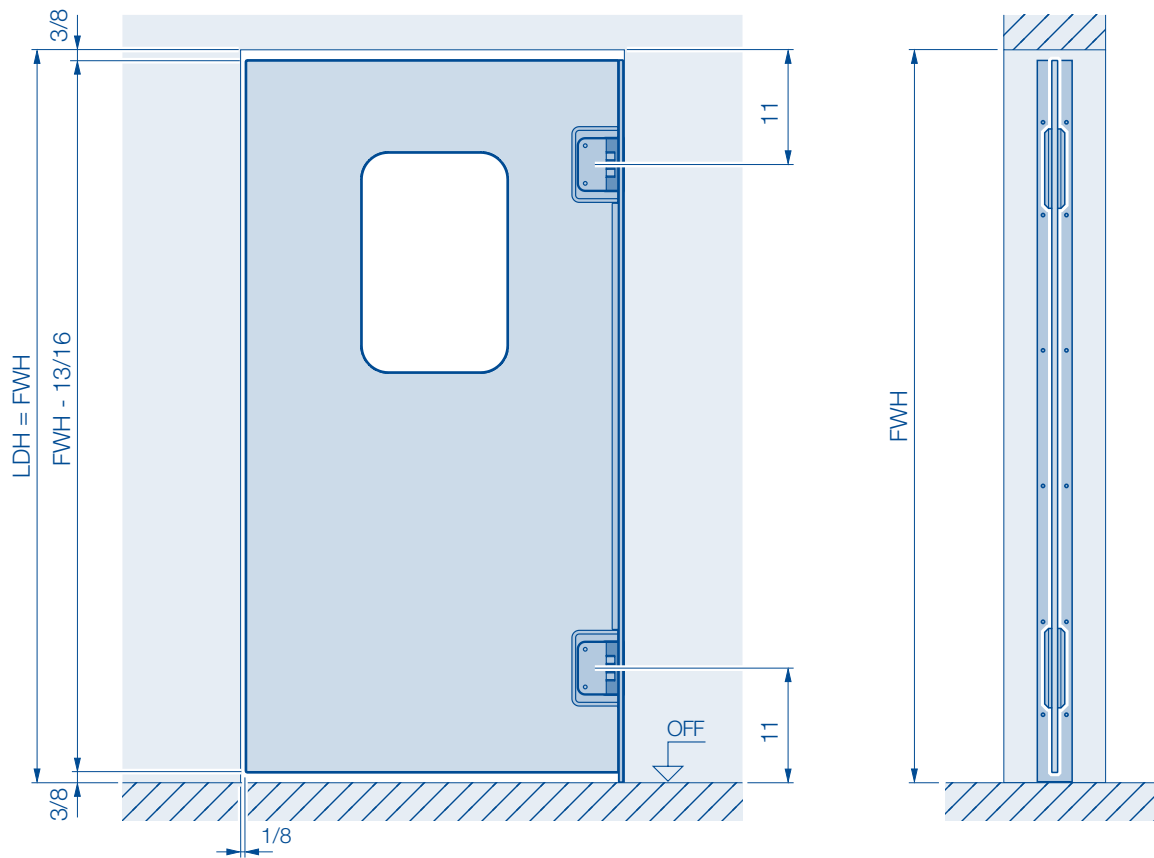

Fastening with mounting plate

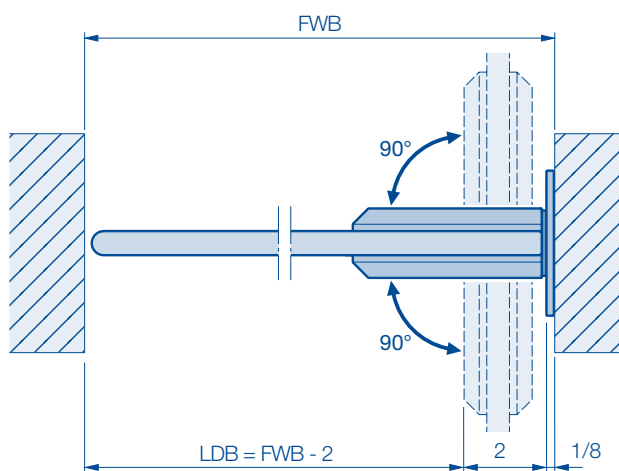

Fastening with flat profile

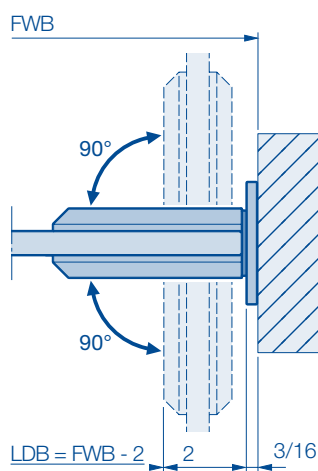

Fastening with flat profile

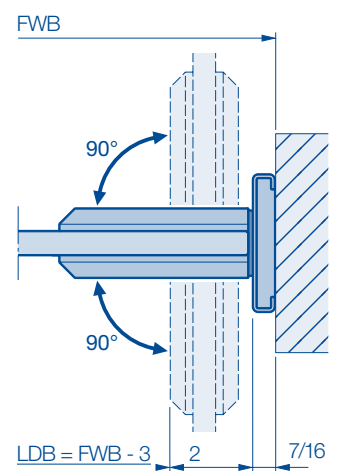

FWB Finished wall opening width
FWH Finished wall opening height
LDB Clear passage width
LDH Clear passage height

OFF Finished floor level

PE Impact Traffic door HPP-180

Installation types for single-panel Impact Traffic doors

(all dimensions in inches)

Installation with profile frame

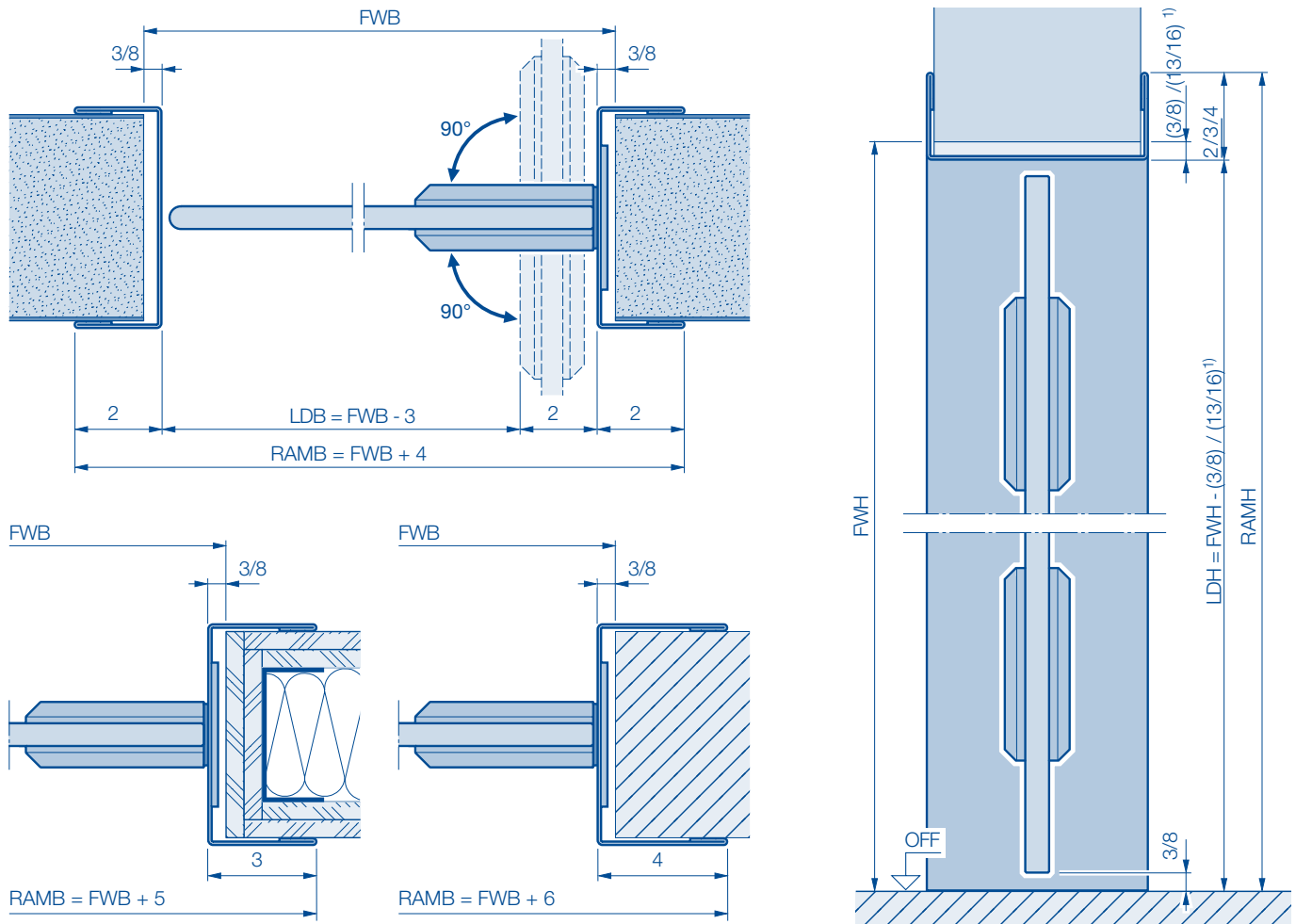

Installation with block frame in front of the wall

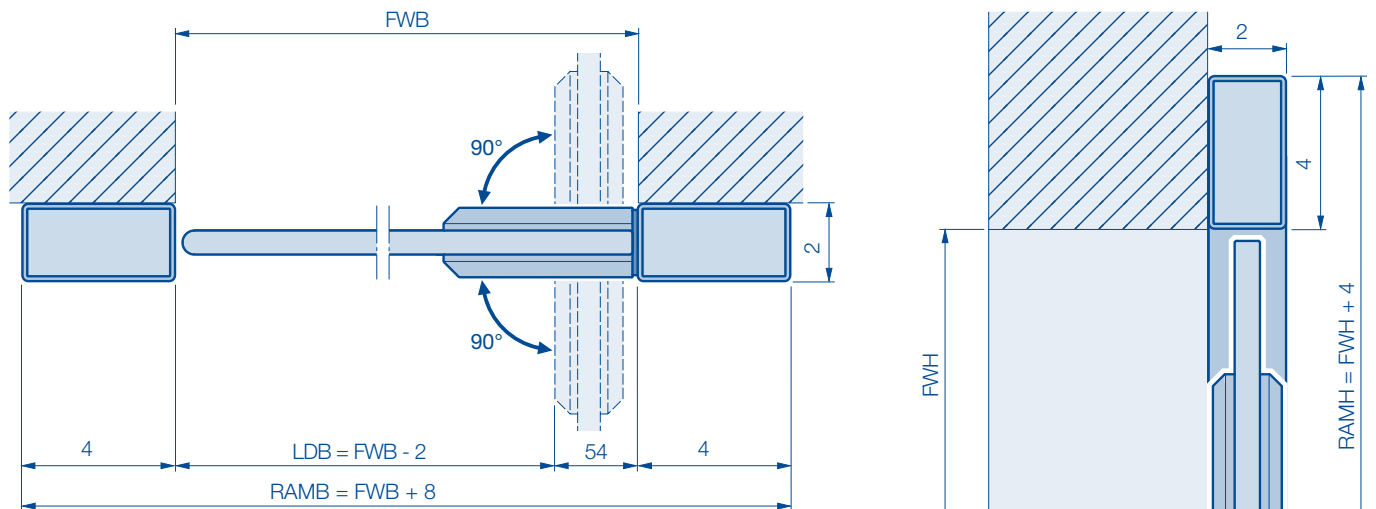

- 1) 3/8 inch for insulated panels / drywall, 13/16 inch for brickwork
FWB Finished wall opening width
FWH Finished wall opening height

- LDB** Clear passage width
LDH Clear passage height
OFF Finished floor level
RAMB Overall frame width

- RAMH** Overall frame height

PE Impact Traffic door

HPP-180

Installation types for double-panel Impact Traffic doors

(all dimensions in inches)

Installation in the opening

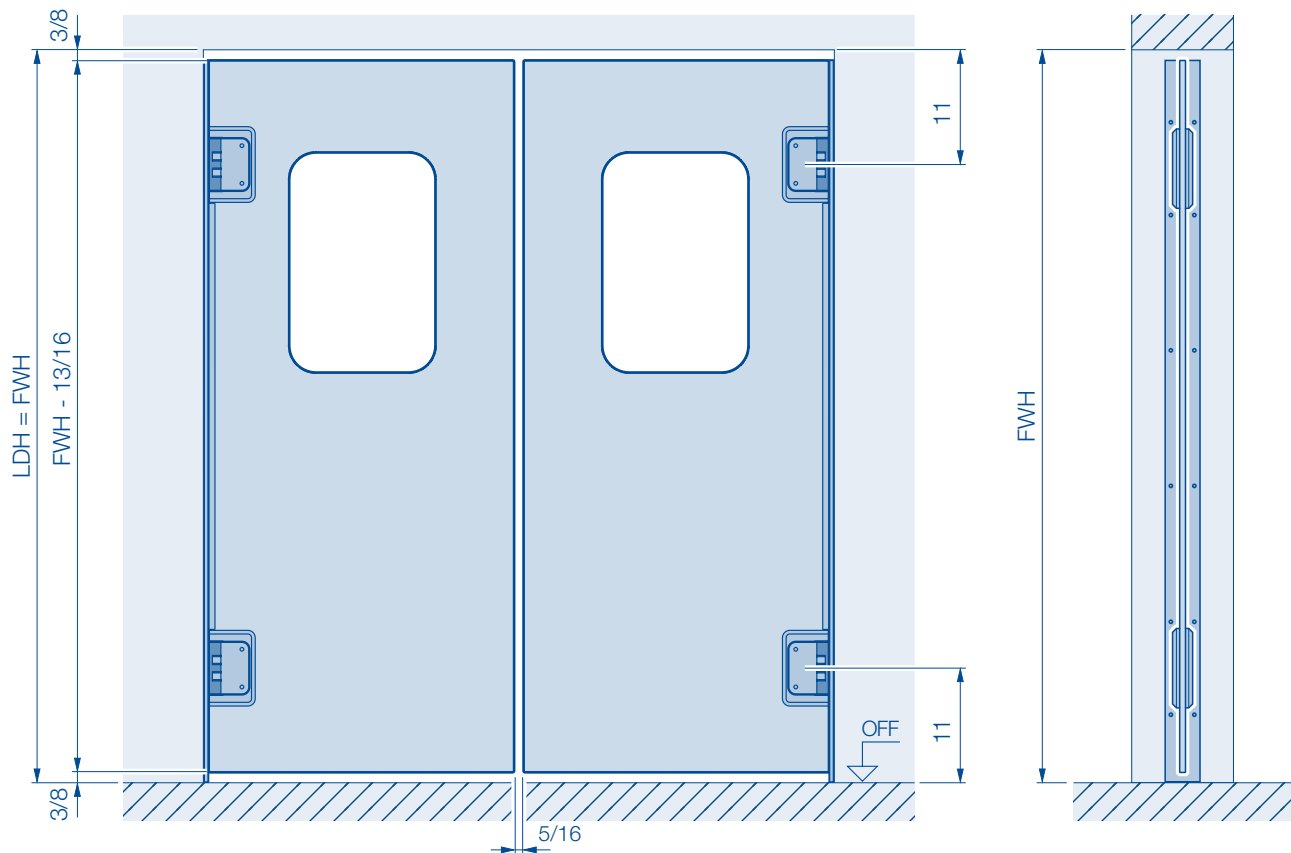

Fastening with mounting plate

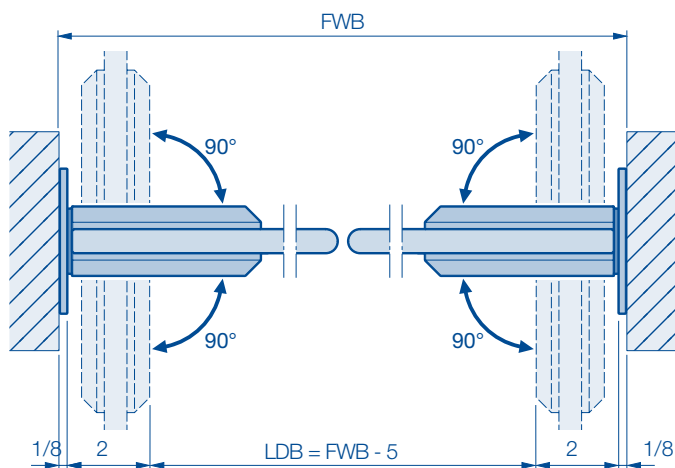

Fastening with flat profile

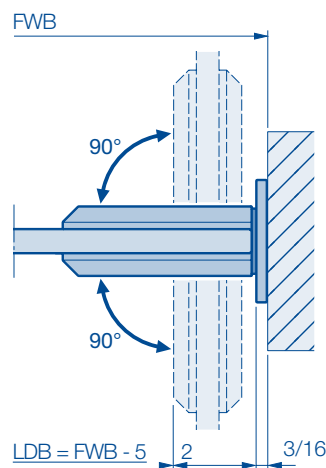

Fastening with flat profile

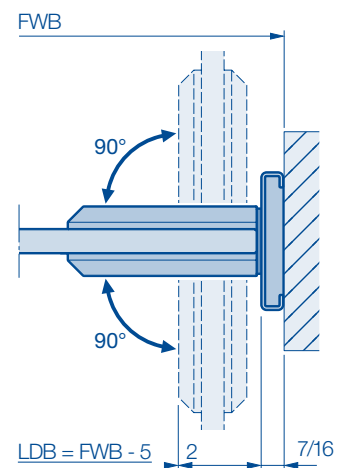

FWB Finished wall opening width
FWH Finished wall opening height
LDB Clear passage width
LDH Clear passage height

OFF Finished floor level

PE Impact Traffic door HPP-180

Installation types for double-panel Impact Traffic doors

(all dimensions in inches)

Installation with profile frame

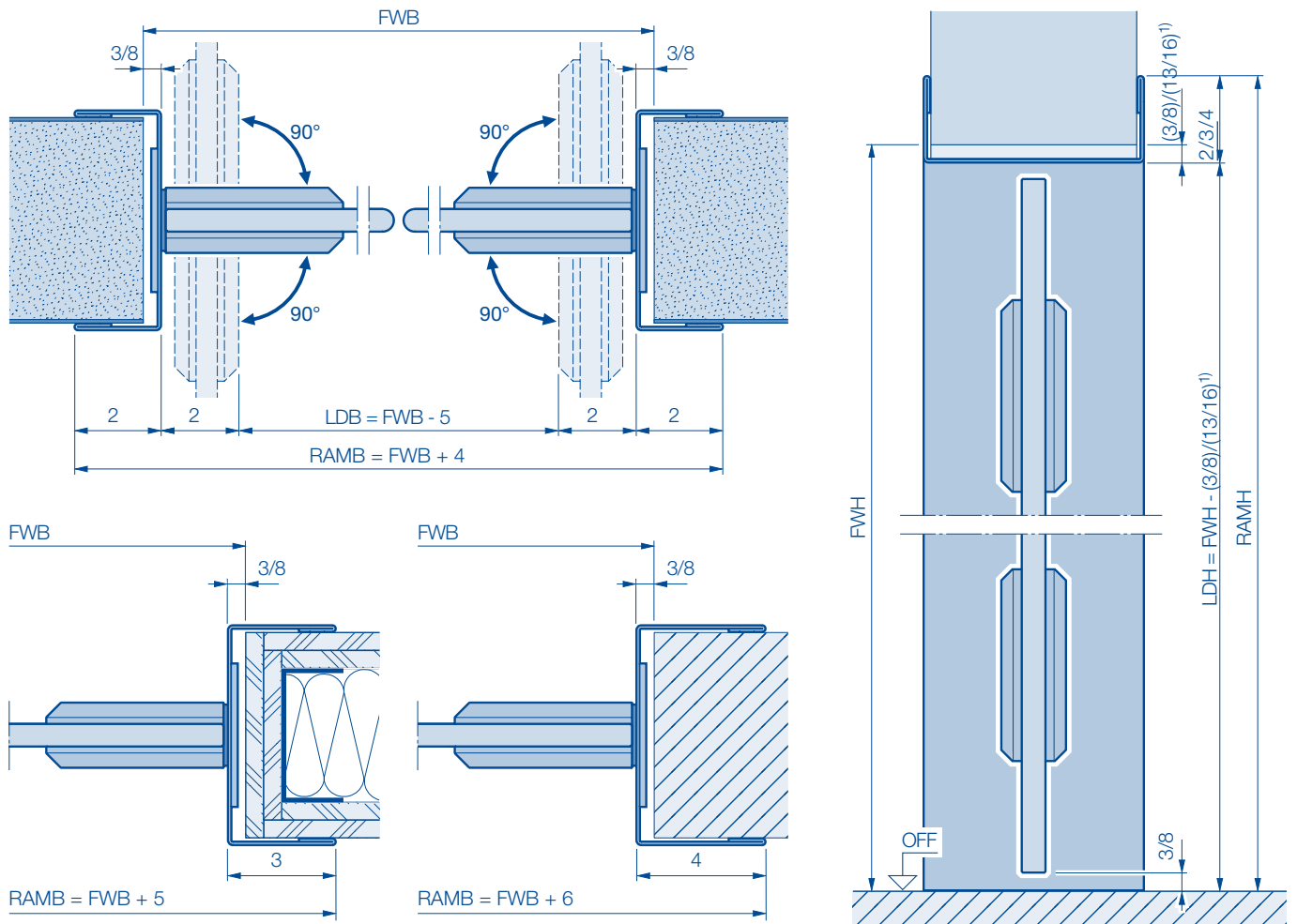

Installation with block frame in front of the wall

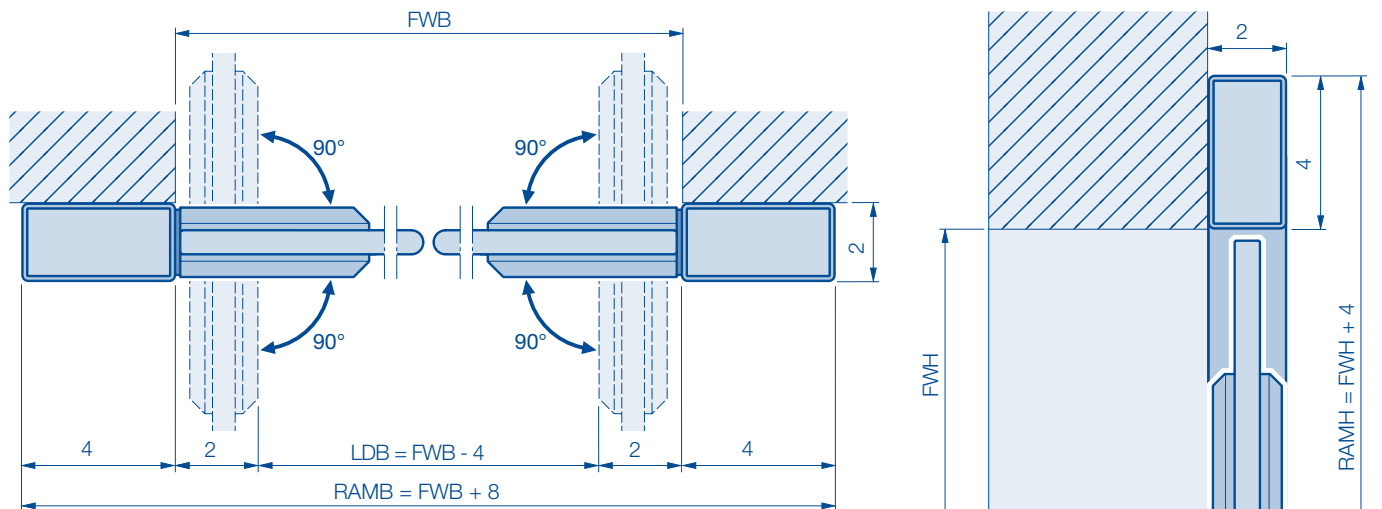

1) 3/8 inch for insulated panels / drywall, 13/16 inch for brickwork
FWB Finished wall opening width
FWH Finished wall opening height

LDB Clear passage width
LDH Clear passage height
OFF Finished floor level
RAMB Overall frame width

RAMH Overall frame height

PE Impact Traffic door HPP-360

Technical data

Fastening according to wall type

(all dimensions in inches)

		HPP-360
Use	Internal door	●
	External door	—
Door panel sizes	Minimum width single-panel	22
	Minimum width double-panel	43
	Maximum width single-panel	63
	Maximum width double-panel	146
	Minimum height	71 *
	Maximum height	181
Wind load resistance		—
Window	rectangular	●
	round	●
	Crescent	○
Window material	Acrylic glass 5/8 inch	●
Window frame material	Polyethylene	○
	Stainless steel V2 A	○
	Stainless steel V4 A	○
Door panel material	Polyethylene PE 500, pressed, 5/8 inch	●
Hinge material	Stainless steel V2 A	●
	Stainless steel V4 A	○
Finger protection	Without PVC finger guard	●
	PVC finger guard	○
	PVC finger guard, cold-resistant	○
Installation type material	Mounting plate 6 × 3 × 1/8 inch V2A, wall thickness ≤ 9 inches	●
Notes: When the maximum wall thickness is exceeded, the opening angle changes.	Mounting plate 6 × 4 × 1/8 inch V2A, wall thickness ≤ 9 inches	●
	Stainless steel flat profile 3 × 3/16 inch V2A, wall thickness ≤ 9 inches	●
	Stainless steel flat profile 4 × 7/16 inch V2A, wall thickness ≤ 9 inches	●
	Profile frame (insulated panel, 2 inches frame face) V2A, wall thickness ≤ 8 inches	●
	Profile frame (drywall, 3 inch frame face) V2A, wall thickness 8 inches	●
	Profile frame (brickwork, 4 inch frame face) V2A, wall thickness ≤ 8 inches	●
	Block frame in front of the wall 4 × 2 inches V2A, wall thickness ≤ 3 inches	●
	Installation methods optionally in V4A	○
Suitable temperatures		-22 °F to +140 °F

● = Standard ○ = Optional * = smaller on request

Material characteristics acc. to (EC) 1935/2004 and (EU) 1245/2020, performance characteristics acc. to EN 14351-2

Fastening according to wall type

	Mounting plate	Flat profile	Profile frame	Block frame in front of the wall
Brickwork / concrete	●	●	●	●
Existing frame	●	●	●	●
Drywall, reinforced	●	●	●	●
Drywall, not reinforced	—	—	●	●
Insulated panels	—	—	●	●

PE Impact Traffic door HPP-360

Size range

(all dimensions in inches)

Size range

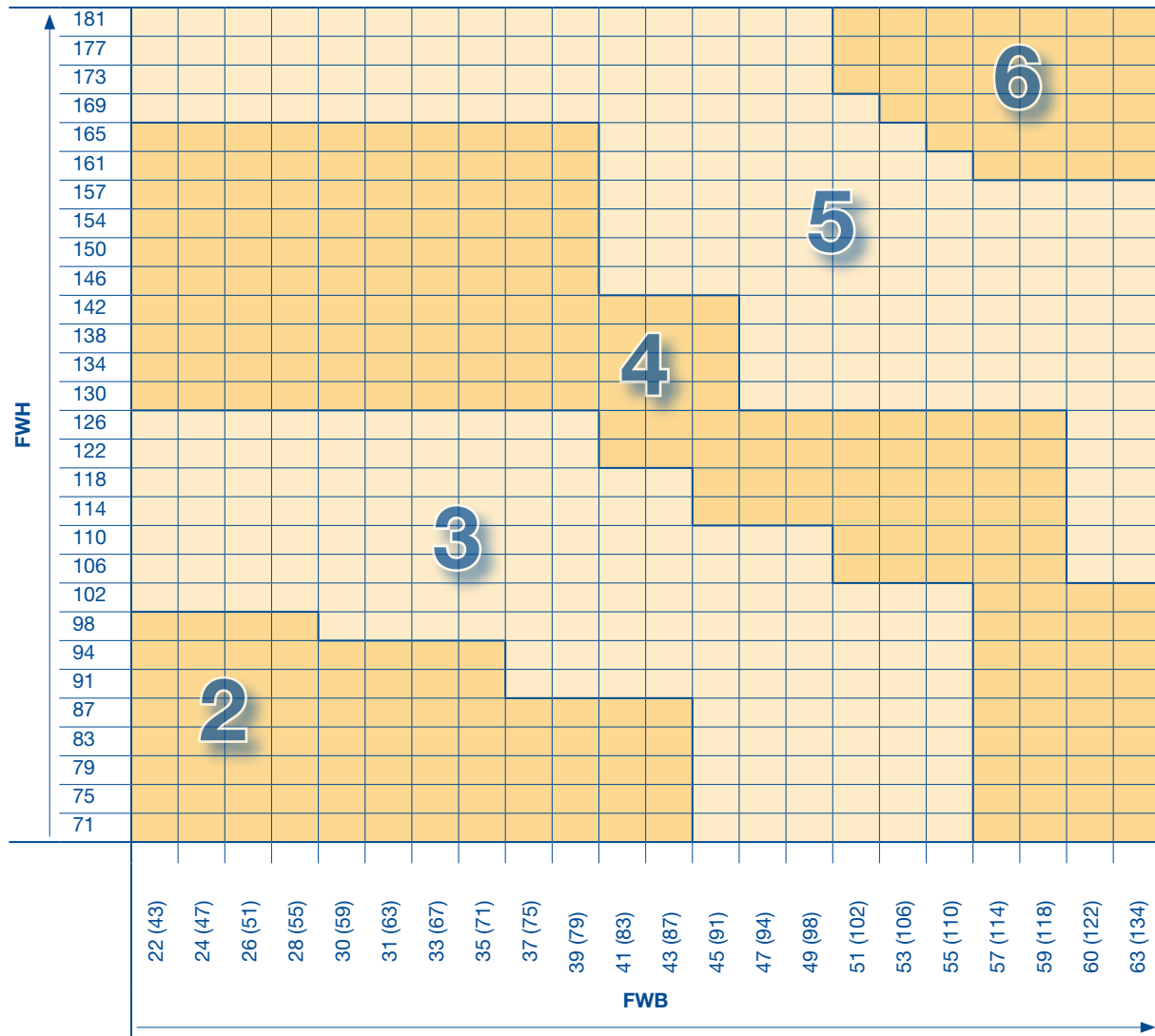

Available dimensions
(number of hinges depending on door size)

FWB Finished wall opening width for single-panel version
(dimensions in brackets for double-panel version)

FWH Finished wall opening height

PE Impact Traffic door

HPP-360

Installation types for single-panel Impact Traffic doors

(all dimensions in inches)

Installation in the opening

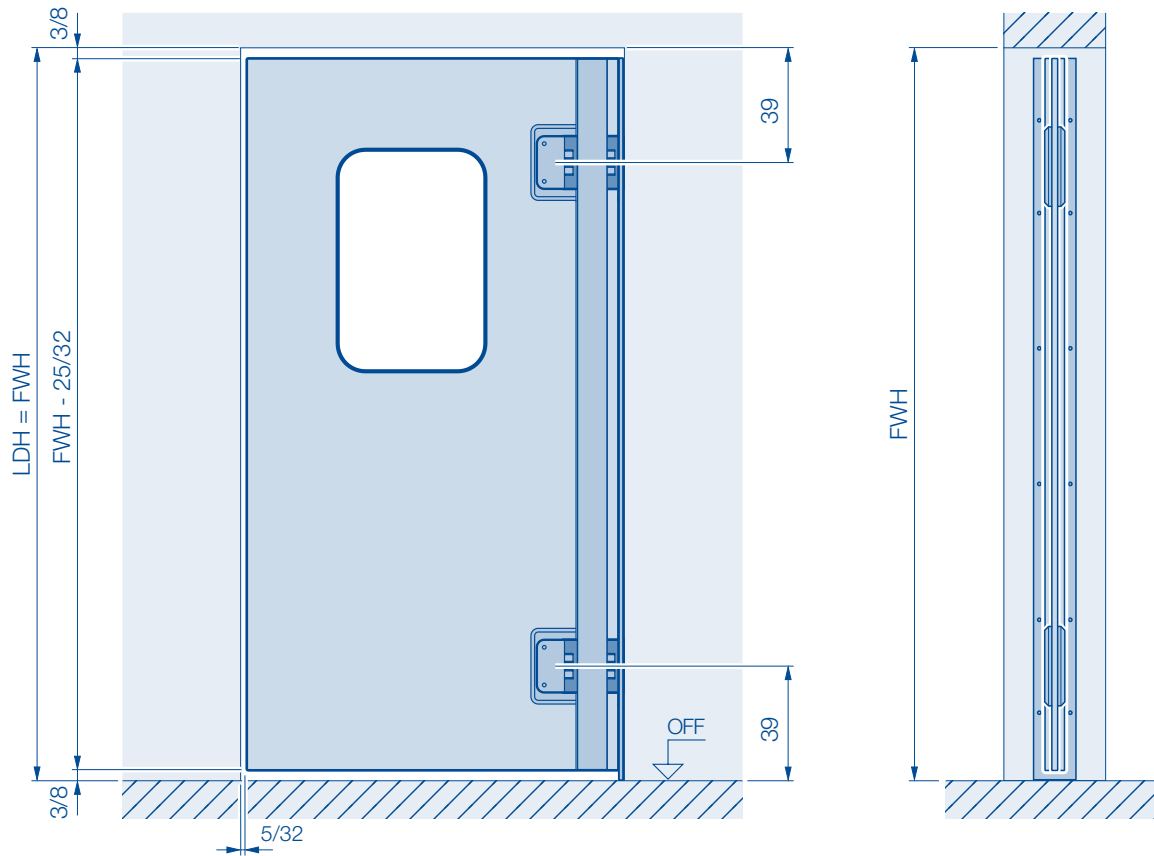

Fastening with mounting plate

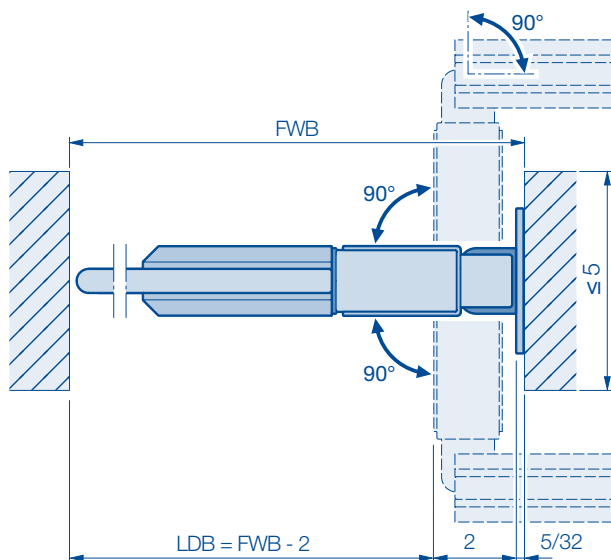

Fastening with flat profile

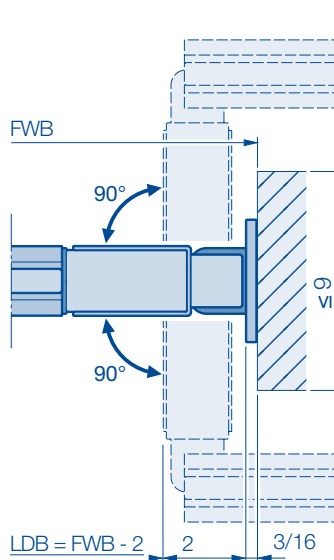

Fastening with flat profile

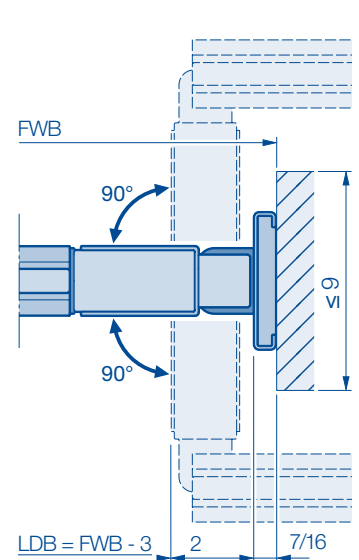

FWB Finished wall opening width
FWH Finished wall opening height
LDB Clear passage width
LDH Clear passage height

OFF Finished floor level

PE Impact Traffic door HPP-360

Installation types for single-panel Impact Traffic doors

(all dimensions in inches)

Installation with profile frame

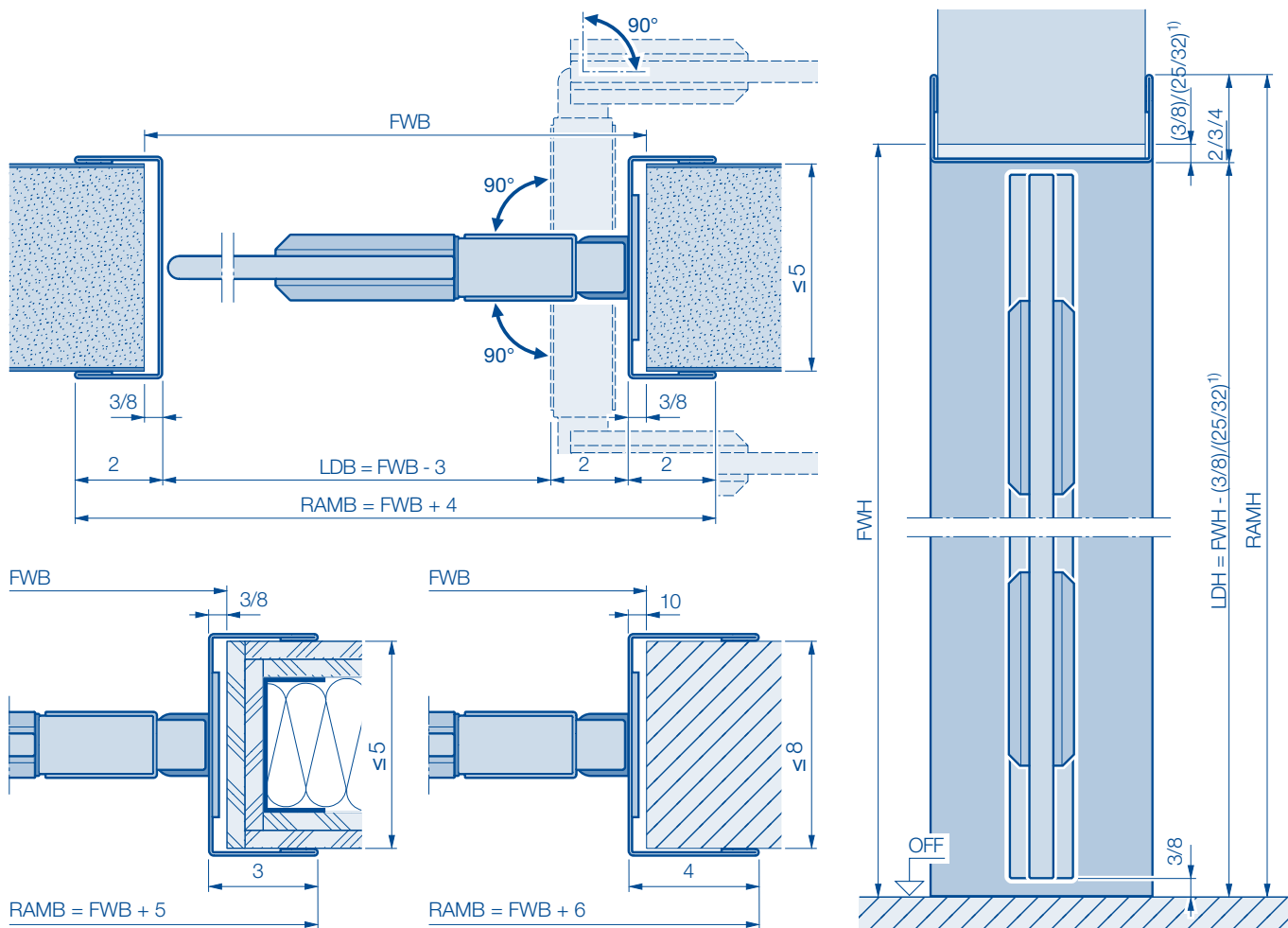

Installation with block frame in front of the wall

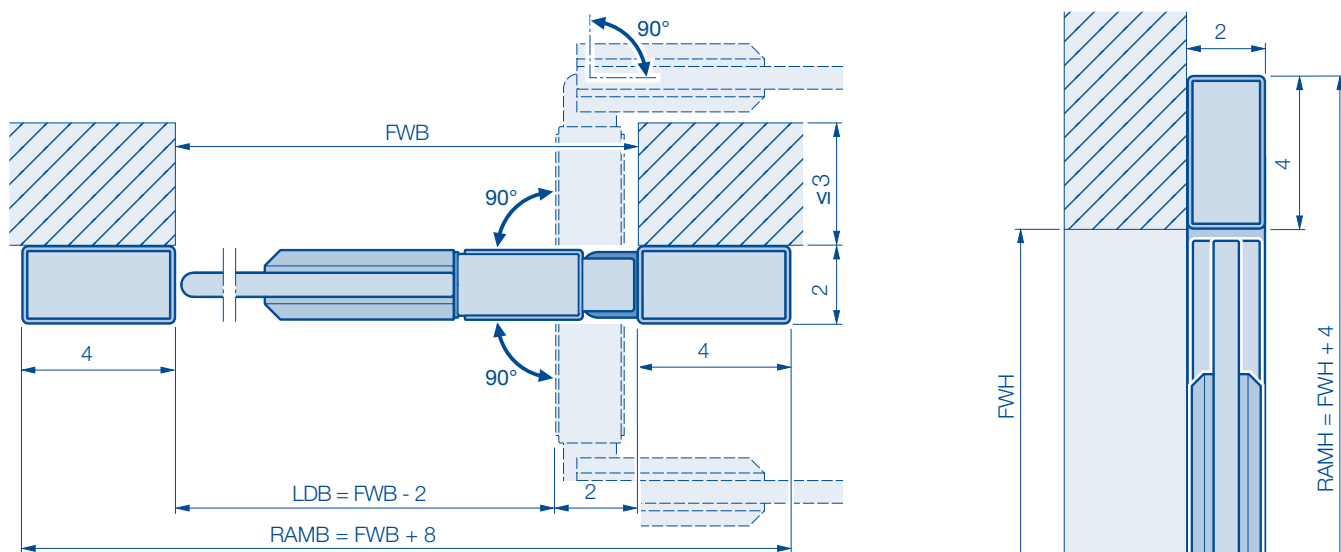

1) 3/8 inch for insulated panels / drywall, 25/32 inch for brickwork
FWB Finished wall opening width
FWH Finished wall opening height

LDB Clear passage width
LDH Clear passage height
OFF Finished floor level
RAMB Overall frame width

RAMH Overall frame height

PE Impact Traffic Door

HPP-360

Installation types for double-panel Impact Traffic doors

(all dimensions in inches)

Installation in the opening

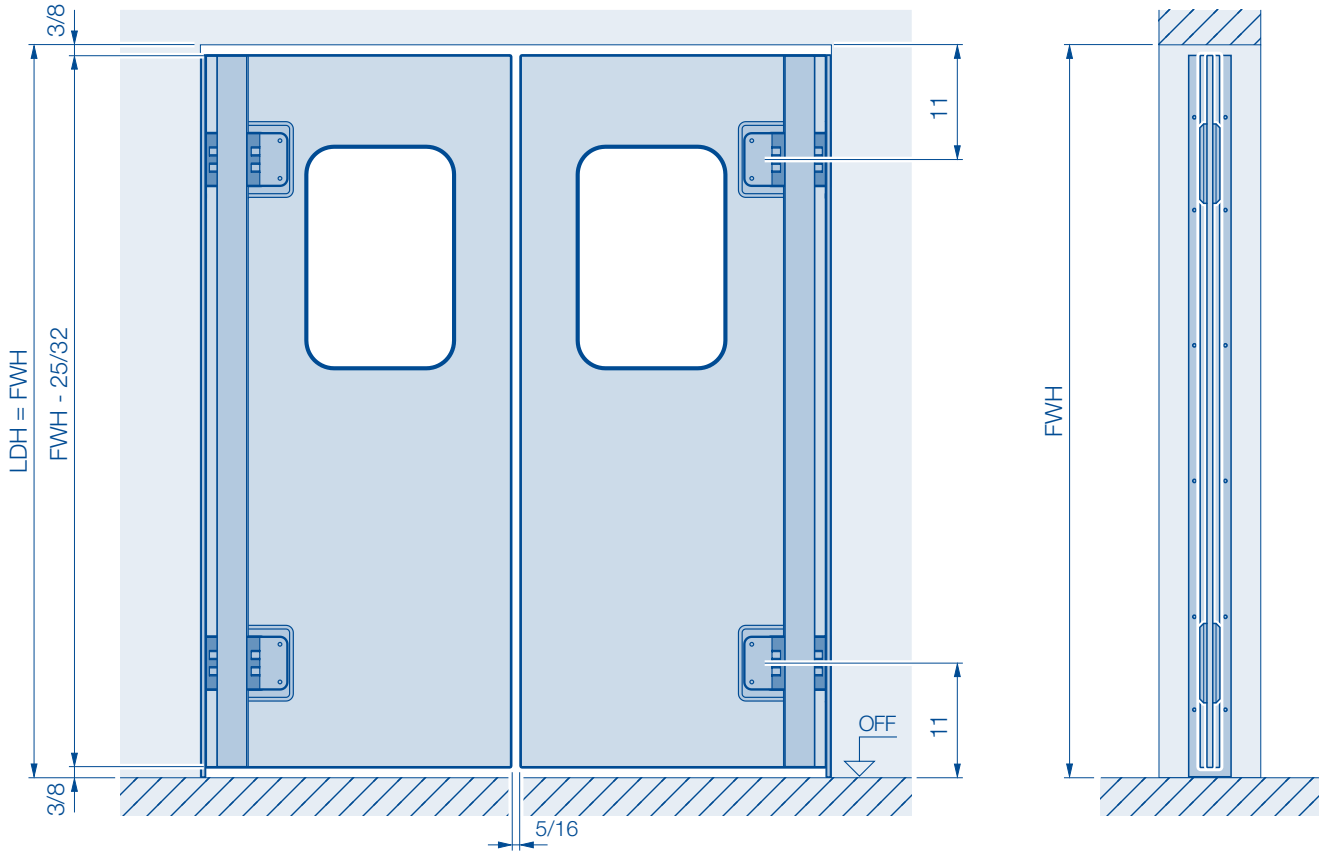

Fastening with mounting plate

Fastening with flat profile

Fastening with flat profile

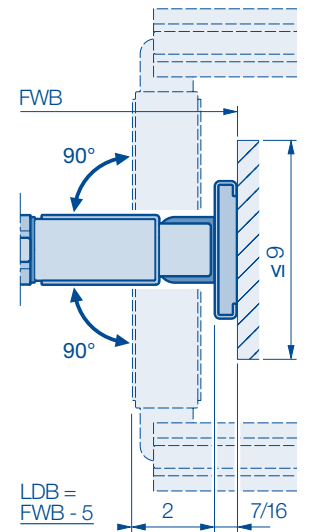
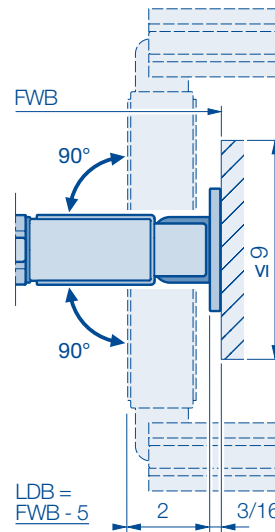
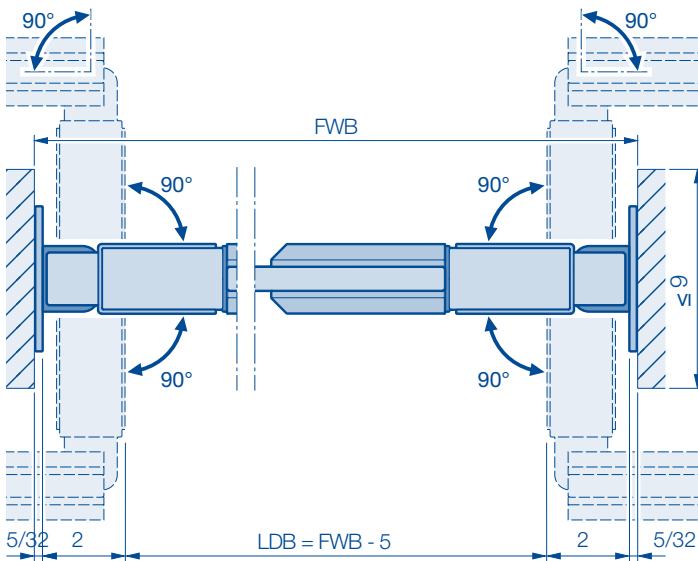

FWB Finished wall opening width
FWH Finished wall opening height
LDB Clear passage width
LDH Clear passage height

OFF Finished floor level

PE Impact Traffic door HPP-360

Installation types for double-panel Impact Traffic doors

(all dimensions in inches)

Installation with profile frame

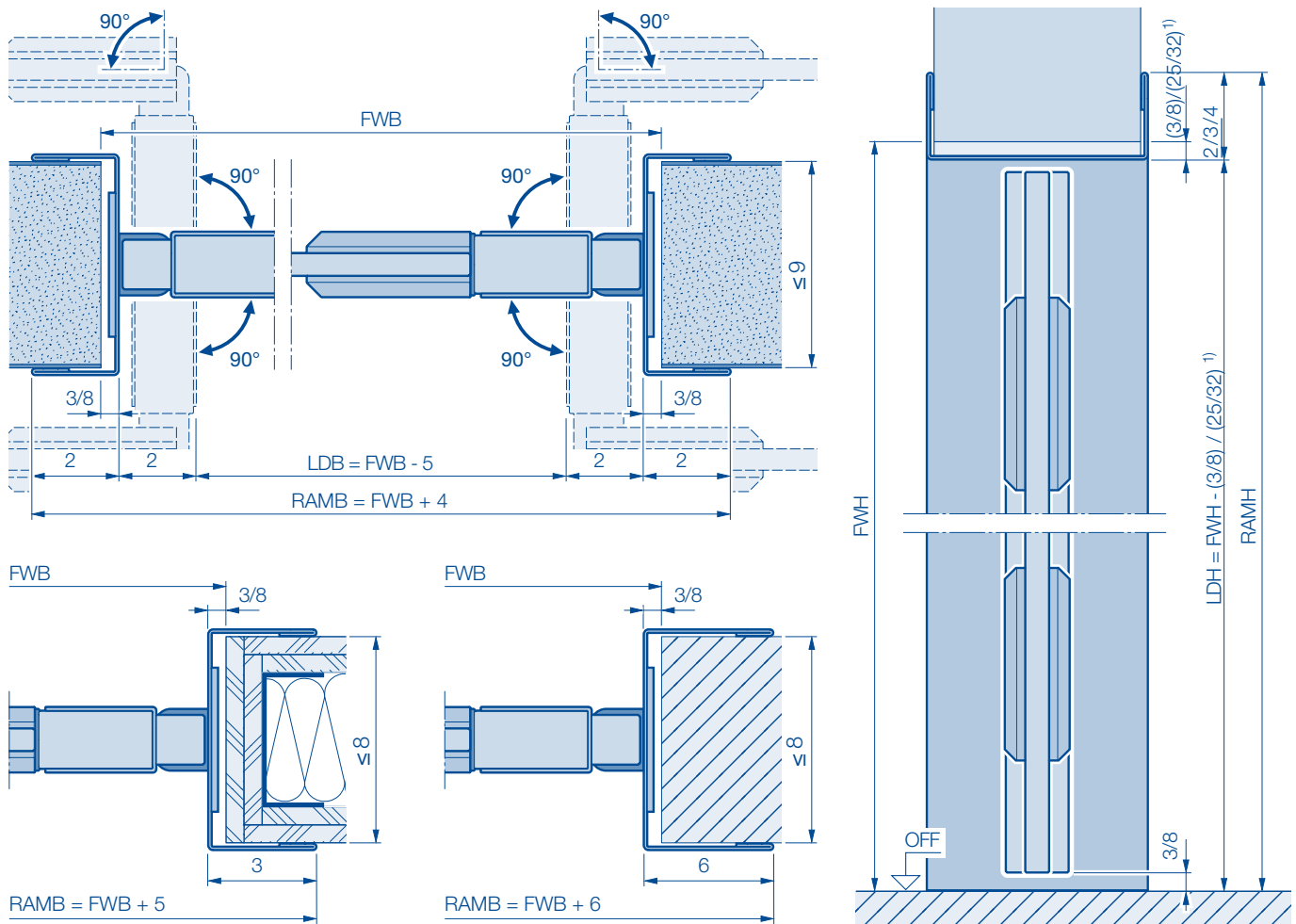

Installation with block frame in front of the wall

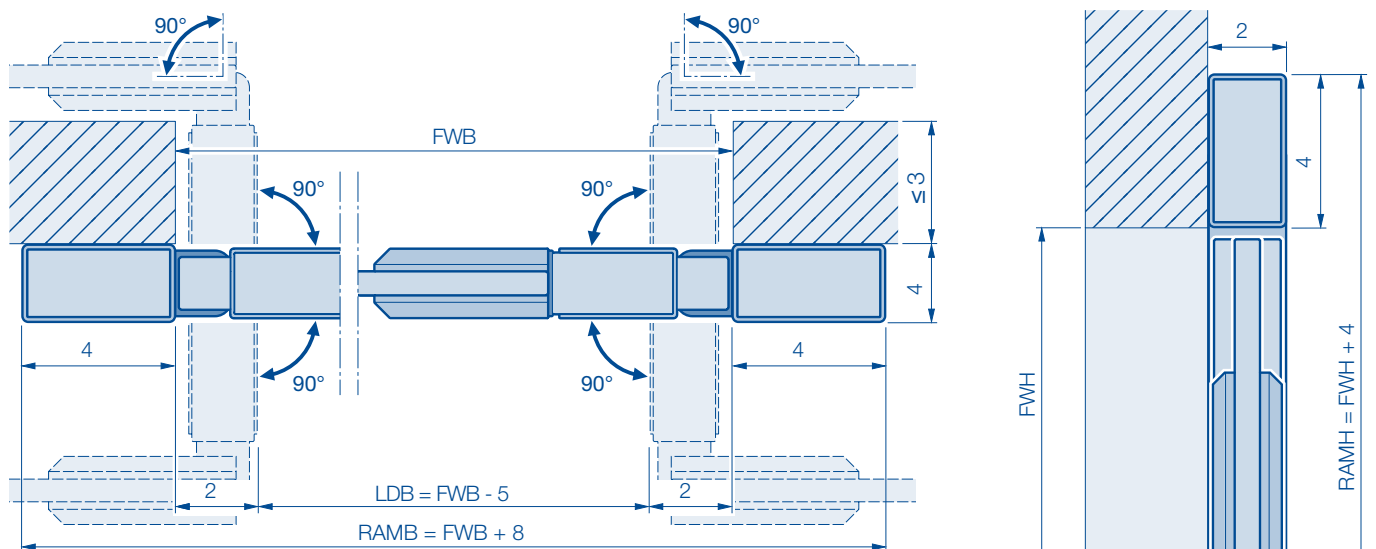

1) 3/8 inch for insulated panels / drywall, 25/32 inch for brickwork
FWB Finished wall opening width
FWH Finished wall opening height

LDB Clear passage width
LDH Clear passage height
OFF Finished floor level
RAMB Overall frame width

RAMH Overall frame height

Brand quality for residential and commercial construction

Hörmann is a family-owned company which offers a wide variety of construction components for building and renovating projects from a single source. We manufacture in highly-specialized factories using the latest production technologies. Furthermore, our employees work constantly on new products, and are always innovating. The results are unique patents and one-of-a-kind products you can depend on.

